

# Leaf chains



**Safety lifting chains.**

Leaf Chains are often a safety-critical component part. For this reason Rexnord Leaf Chains are supplied marked with a batch number. This allows traceability to process and inspection records right back to the raw material and its supplier.

## Leaf chains, odd lacings

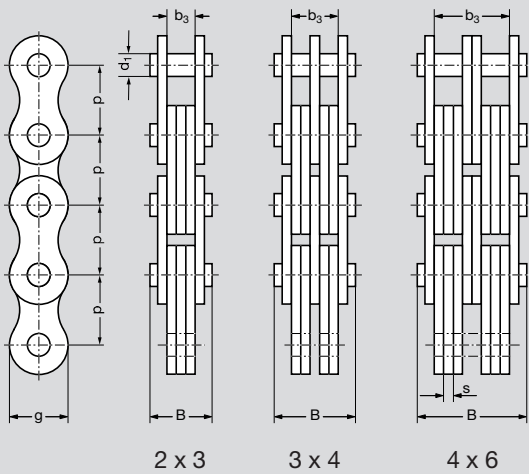

## Leaf chains, even lacings

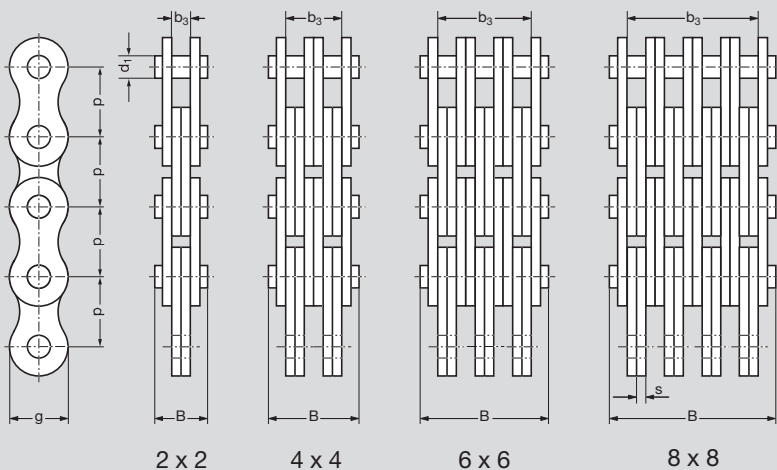

## Leaf chains acc. to ISO 4347 / DIN 8152, American standard, Heavy series

| Chain No. | Chain description<br>ISO<br>DIN | Pitch<br>p |        | Plate combinations | Pin<br>∅<br>d <sub>1</sub> max.<br>mm | Link plate height<br>g<br>mm | Link plate thick<br>s<br>mm | Length over<br>100 x Pitch<br>■<br>mm | Total width<br>B max.<br>mm | Bearing area<br>A<br>cm <sup>2</sup> | Link plate width<br>b <sub>3</sub> min.<br>mm | Min. ultimate strength required*)<br>acc. to DIVISO<br>F <sub>B</sub><br>N | Weight<br>≈ q<br>kg/m |
|-----------|---------------------------------|------------|--------|--------------------|---------------------------------------|------------------------------|-----------------------------|---------------------------------------|-----------------------------|--------------------------------------|---|--|-----------------------|
|           |                                 | inch       | mm     |                    |                                       |                              |                             |                                       |                             |                                      |   |  |                       |
| BL 422    | LH 0822                         | 0.50       | 12.7   | 2 x 2              | 5.08                                  | 11.7                         | 2.0                         | 1277                                  | 10.9                        | 0.20                                 | 4.2   | 22 200   | 0.60                  |
| BL 423    | LH 0823                         |            |        | 2 x 3              |                                       |                              |                             |                                       | 13.0                        | 0.30                                 | 6.3   | 22 200   | 0.65                  |
| BL 434    | LH 0834                         |            |        | 3 x 4              |                                       |                              |                             |                                       | 17.1                        | 0.41                                 | 10.5  | 33 300   | 0.90                  |
| BL 444    | LH 0844                         |            |        | 4 x 4              |                                       |                              |                             |                                       | 19.25                       | 0.41                                 | 12.6  | 44 400   | 1.02                  |
| BL 446    | LH 0846                         |            |        | 4 x 6              |                                       |                              |                             |                                       | 23.45                       | 0.61                                 | 16.8  | 44 400   | 1.26                  |
| BL 466    | LH 0866                         |            |        | 6 x 6              |                                       |                              |                             |                                       | 27.6                        | 0.61                                 | 21.0  | 66 600   | 1.51                  |
| BL 523    | LH 1023                         | 0.625      | 15.875 | 2 x 3              | 5.94                                  | 14.6                         | 2.4                         | 1596                                  | 15.0                        | 0.43                                 | 7.4   | 33 400   | 1.1                   |
| BL 534    | LH 1034                         |            |        | 3 x 4              |                                       |                              |                             |                                       | 20.0                        | 0.57                                 | 12.3  | 50 100   | 1.5                   |
| BL 544    | LH 1044                         |            |        | 4 x 4              |                                       |                              |                             |                                       | 22.5                        | 0.57                                 | 14.7  | 66 800   | 1.8                   |
| BL 546    | LH 1046                         |            |        | 4 x 6              |                                       |                              |                             |                                       | 27.3                        | 0.86                                 | 19.6  | 66 800   | 2.2                   |
| BL 566    | LH 1066                         |            |        | 6 x 6              |                                       |                              |                             |                                       | 32.3                        | 0.86                                 | 24.5  | 100 200  | 2.6                   |
| BL 588    | LH 1088                         |            |        | 8 x 8              |                                       |                              |                             |                                       | 42.2                        | 1.14                                 | 34.3  | 133 600  | 3.4                   |
| BL 622    | LH 1222                         | 0.75       | 19.05  | 2 x 2              | 7.92                                  | 17.8                         | 3.1                         | 1908                                  | 16.6                        | 0.51                                 | 6.4   | 48 900   | 1.5                   |
| BL 623    | LH 1223                         |            |        | 2 x 3              |                                       |                              |                             |                                       | 19.9                        | 0.74                                 | 9.6   | 48 900   | 1.8                   |
| BL 634    | LH 1234                         |            |        | 3 x 4              |                                       |                              |                             |                                       | 26.5                        | 0.98                                 | 16.0  | 73 400   | 2.5                   |
| BL 644    | LH 1244                         |            |        | 4 x 4              |                                       |                              |                             |                                       | 29.7                        | 0.98                                 | 19.3  | 97 800   | 2.9                   |
| BL 646    | LH 1246                         |            |        | 4 x 6              |                                       |                              |                             |                                       | 36.3                        | 1.47                                 | 25.8  | 97 800   | 3.6                   |
| BL 666    | LH 1266                         |            |        | 6 x 6              |                                       |                              |                             |                                       | 42.7                        | 1.47                                 | 32.2  | 146 900  | 4.3                   |
| BL 822    | LH 1622                         | 1.00       | 25.4   | 2 x 2              | 9.53                                  | 23.6                         | 4.0                         | 2540                                  | 20.6                        | 0.74                                 | 8.2   | 84 500   | 2.4                   |
| BL 823    | LH 1623                         |            |        | 2 x 3              |                                       |                              |                             |                                       | 24.8                        | 1.14                                 | 12.3  | 84 500   | 3.0                   |
| BL 834    | LH 1634                         |            |        | 3 x 4              |                                       |                              |                             |                                       | 33.1                        | 1.52                                 | 20.5  | 126 800  | 4.2                   |
| BL 844    | LH 1644                         |            |        | 4 x 4              |                                       |                              |                             |                                       | 37.3                        | 1.52                                 | 24.7  | 169 000  | 4.8                   |
| BL 846    | LH 1646                         |            |        | 4 x 6              |                                       |                              |                             |                                       | 45.7                        | 2.29                                 | 33.0  | 169 000  | 6.0                   |
| BL 866    | LH 1666                         |            |        | 6 x 6              |                                       |                              |                             |                                       | 54.0                        | 2.29                                 | 41.3  | 253 600  | 7.2                   |
| BL 888    | LH 1688                         | 8 x 8      | 70.7   | 2.97               | 57.9                                  | 338 000                      | 9.6                         |                                       |                             |                                      |   |  |                       |
| BL 1023   | LH 2023                         | 1.25       | 31.75  | 2 x 3              | 11.1                                  | 29.2                         | 4.7                         | 3179                                  | 28.9                        | 1.56                                 | 14.4  | 115 600  | 4.4                   |
| BL 1034   | LH 2034                         |            |        | 3 x 4              |                                       |                              |                             |                                       | 38.7                        | 2.09                                 | 24.0  | 173 400  | 6.2                   |
| BL 1044   | LH 2044                         |            |        | 4 x 4              |                                       |                              |                             |                                       | 43.7                        | 2.09                                 | 28.8  | 231 200  | 7.0                   |
| BL 1046   | LH 2046                         |            |        | 4 x 6              |                                       |                              |                             |                                       | 53.5                        | 3.12                                 | 38.4  | 231 200  | 8.7                   |
| BL 1066   | LH 2066                         |            |        | 6 x 6              |                                       |                              |                             |                                       | 63.4                        | 3.12                                 | 48.0  | 346 800  | 10.5                  |
| BL 1088   | LH 2088                         |            |        | 8 x 8              |                                       |                              |                             |                                       | 83.0                        | 4.17                                 | 67.2  | 462 400  | 13.9                  |
| BL 1223   | LH 2423                         | 1.50       | 38.1   | 2 x 3              | 12.7                                  | 34.4                         | 5.5                         | 3812                                  | 33.6                        | 2.10                                 | 16.8  | 151 200  | 6.0                   |
| BL 1234   | LH 2434                         |            |        | 3 x 4              |                                       |                              |                             |                                       | 45.5                        | 2.79                                 | 28.0  | 226 800  | 8.3                   |
| BL 1244   | LH 2444                         |            |        | 4 x 4              |                                       |                              |                             |                                       | 51.2                        | 2.79                                 | 33.6  | 302 400  | 9.5                   |
| BL 1246   | LH 2446                         |            |        | 4 x 6              |                                       |                              |                             |                                       | 62.7                        | 4.2                                  | 44.8  | 302 400  | 11.8                  |
| BL 1266   | LH 2466                         |            |        | 6 x 6              |                                       |                              |                             |                                       | 74.5                        | 4.2                                  | 56.0  | 453 600  | 14.1                  |
| BL 1288   | LH 2488                         |            |        | 8 x 8              |                                       |                              |                             |                                       | 97.8                        | 5.4                                  | 78.4  | 604 800  | 18.8                  |
| BL 1423   | LH 2823                         | 1.75       | 44.45  | 2 x 3              | 14.27                                 | 40.8                         | 6.3                         | 4445                                  | 38.2                        | 2.7                                  | 19.2  | 191 300  | 8.3                   |
| BL 1434   | LH 2834                         |            |        | 3 x 4              |                                       |                              |                             |                                       | 51.7                        | 3.6                                  | 32.0  | 287 000  | 11.6                  |
| BL 1444   | LH 2844                         |            |        | 4 x 4              |                                       |                              |                             |                                       | 58.2                        | 3.6                                  | 38.4  | 382 600  | 13.2                  |
| BL 1446   | LH 2846                         |            |        | 4 x 6              |                                       |                              |                             |                                       | 71.5                        | 5.4                                  | 51.2  | 382 600  | 16.4                  |
| BL 1466   | LH 2866                         |            |        | 6 x 6              |                                       |                              |                             |                                       | 85.0                        | 5.4                                  | 64.0  | 574 000  | 19.7                  |
| BL 1488   | LH 2888                         |            |        | 8 x 8              |                                       |                              |                             |                                       | 111.7                       | 7.2                                  | 89.6  | 765 200  | 25.9                  |
| BL 1623   | LH 3223                         | 2.00       | 50.8   | 2 x 3              | 17.46                                 | 47.9                         | 7.0                         | 5080                                  | 42.1                        | 3.67                                 | 21.3  | 289 100  | 11.0                  |
| BL 1634   | LH 3234                         |            |        | 3 x 4              |                                       |                              |                             |                                       | 57.0                        | 4.89                                 | 35.5  | 433 700  | 15.4                  |
| BL 1644   | LH 3244                         |            |        | 4 x 4              |                                       |                              |                             |                                       | 63.8                        | 5.0                                  | 42.6  | 578 200  | 17.5                  |
| BL 1646   | LH 3246                         |            |        | 4 x 6              |                                       |                              |                             |                                       | 78.9                        | 7.33                                 | 56.8  | 578 200  | 21.8                  |
| BL 1666   | LH 3266                         |            |        | 6 x 6              |                                       |                              |                             |                                       | 95.0                        | 7.33                                 | 71.0  | 867 400  | 26.2                  |
| BL 1688   | LH 3288                         |            |        | 8 x 8              |                                       |                              |                             |                                       | 125.6                       | 9.78                                 | 99.4  | 1 156 400  | 34.9                  |

BL leaf chains can be directly fastened by using connecting pins. They do not need additional end plates.

Wherever possible, it is best to select BL- leaf chains.

Further plate combinations upon request.

Please note the following the specs.:

Length over 100 x Pitch

■ chain length: Tolerance ± 0.25 % of uncoiled chain under measured load. Measured force =  $\frac{F_B}{100}$

F = pin and plate dimensions correspond to roller chain series acc. to DIN 8187.

AL = pin and plate dimensions correspond to ANSI standard.

BL = pin and plate dimensions correspond to ANSI standard, however these leaf chains possess the plate thickness and pin ∅ of the next largest corresponding chain size, to achieve a larger bearing area and tensile strength, and consequently longer working life for the BL leaf chains.

\*) Details about the effective higher Rexnord ultimate strengths and fatigue strength values are available upon request.

# Leaf chains



**F Series:**  
Machine tool quality.

Use machine tool chains from the "F" series in special machine tool quality!

The effective pitch dimensions for leaf chains from the series F and AL vary somewhat from the theoretical values. Please note the following specs.: "Length over 100 x Pitch".

■ Chain length: Tolerance  $\pm 0,25\%$  of uncoiled chain under measured load. Measured force =  $\frac{F_B}{100}$

## Leaf chains, Lacings

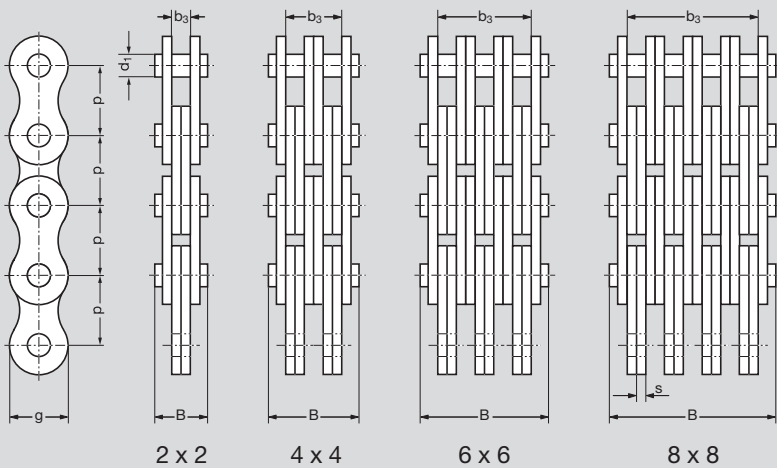

## Leaf chains, Industry standard

| Chain No.    | Chain description | Pitch p |        | Plate combinations | Pin $\varnothing$ | Link plate height | Link plate thick | Length over 100 x Pitch | Total width | Bearing area | Min. ultimate strength*) | Weight |
|--------------|-------------------|---------|--------|--------------------|-------------------|-------------------|------------------|-------------------------|-------------|--------------|--------------------------|--------|
|              |                   | inch    | mm     |                    |                   |                   |                  |                         |             |              |                          |        |
| F 6 H - 5    | —                 | 0.625   | 15.875 | 2 x 3              | 4.75              | 14.6              | 2.5              | 1592                    | 14.9        | 0.24         | 30 300                   | 1.0    |
| F 19 V - 44  | —                 | 0.75    | 19.05  | 4 x 4              | 6.5               | 15.2              | 2.35             | 1905                    | 22.8        | 0.61         | 71 000                   | 1.7    |
| F 19 V - 66  | —                 | —       | —      | 6 x 6              | —                 | —                 | —                | —                       | 32.7        | 0.91         | 106 000                  | 2.5    |
| 834 (SK 507) | —                 | 1.00    | 25.4   | 3 x 4              | 10.85             | 23.4              | IL /AL           | 2544                    | 28.4        | 1.37         | 125 000                  | 3.6    |
| 432 (SK 508) | —                 | —       | —      | 6 x 6              | —                 | —                 | 3.05/4.0         | —                       | 44.4        | 2.06         | 250 000                  | 5.9    |

\*) Details about the effective higher Rexnord ultimate strengths and fatigue strength values are available upon request.

### Leaf chains acc. to ISO 4347 / DIN 8152, European standard, Light series

| Chain No. | Chain description<br>ISO DIN | Pitch p |        | Plate combinations | Pin $\varnothing$<br>d <sub>1</sub> max. mm | Link plate height<br>g mm | Link plate thick<br>s mm | Length over 100 x Pitch<br>■ mm | Total width<br>B max. mm | Bearing area<br>A cm <sup>2</sup> | Link plate width<br>b <sub>3</sub> min. mm | Min. ultimate strength required*)<br>acc. to DIN/ISO<br>F <sub>B</sub> N | Weight<br>≈ q kg/m |
|-----------|------------------------------|---------|--------|--------------------|---|---------------------------|--------------------------|---------------------------------|--------------------------|-----------------------------------|--|--|--------------------|
|           |                              | inch    | mm     |                    |   |                           |                          |                                 |                          |                                   |  |  |                    |
|           |                              |         |        |                    |   |                           |                          |                                 |                          |                                   |  |  |                    |
| F 12 – 44 | LL 0844                      | 0,50    | 12,7   | 4 x 4              | 4,45  | 10,4                      | 1,5                      | 1270                            | 15,0                     | 0,27                              | 9,1  | 36 000   | 0,83               |
| F 12 – 66 | LL 0866                      |         |        | 6 x 6              |   |                           |                          |                                 | 21,3                     | 0,40                              | 15,2                                       | 54 000   | 1,25               |
| F 15 – 44 | LL 1044                      | 0,625   | 15,875 | 4 x 4              | 5,08  | 12,8                      | 1,5                      | 1588                            | 15,2                     | 0,30                              | 9,6  | 44 800   | 0,92               |
| F 15 – 66 | LL 1066                      |         |        | 6 x 6              |   |                           |                          |                                 | 21,7                     | 0,46                              | 16,0                                       | 67 200   | 1,4                |
| F 19 – 44 | LL 1244                      | 0,75    | 19,05  | 4 x 4              | 5,72  | 15,9                      | 1,8                      | 1890                            | 18,0                     | 0,41                              | 11,4                                       | 59 000   | 1,4                |
| F 19 – 66 | LL 1266                      |         |        | 6 x 6              |   |                           |                          |                                 | 25,7                     | 0,62                              | 19,0                                       | 88 500   | 2,1                |
| F 25 – 44 | LL 1644                      | 1,00    | 25,4   | 4 x 4              | 8,28  | 20,5                      | 3,0                      | 2540                            | 28,4                     | 0,99                              | 18,6                                       | 120 000  | 2,9                |
| F 25 – 66 | LL 1666                      |         |        | 6 x 6              |   |                           |                          |                                 | 40,7                     | 1,49                              | 31,0                                       | 180 000  | 4,3                |
| F 25 – 88 | LL 1688                      |         |        | 8 x 8              |   |                           |                          |                                 | 53,0                     | 1,98                              | 43,4                                       | 240 000  | 5,8                |
| F 31 – 44 | LL 2044                      | 1,25    | 31,75  | 4 x 4              | 10,19                                       | 25,7                      | 3,5                      | 3160                            | 33,5                     | 1,42                              | 21,6                                       | 190 000  | 4,3                |
| F 31 – 66 | LL 2066                      |         |        | 6 x 6              |   |                           |                          |                                 | 48,2                     | 2,12                              | 36,0                                       | 285 000  | 6,4                |
| F 31 – 88 | LL 2088                      |         |        | 8 x 8              |   |                           |                          |                                 | 62,9                     | 2,83                              | 50,4                                       | 380 000  | 8,4                |
| F 38 – 44 | LL 2444                      | 1,50    | 38,1   | 4 x 4              | 14,63                                       | 33,0                      | 5,0                      | 3785                            | 46,9                     | 2,91                              | 31,2                                       | 320 000  | 8,2                |
| F 38 – 66 | LL 2466                      |         |        | 6 x 6              |   |                           |                          |                                 | 68,3                     | 4,37                              | 52,4                                       | 480 000  | 12,2               |
| F 38 – 88 | LL 2488                      |         |        | 8 x 8              |   |                           |                          |                                 | 89,7                     | 5,82                              | 73,5                                       | 640 000  | 16,2               |
| F 44 – 22 | LL 2822                      | 1,75    | 44,45  | 2 x 2              | 15,9  | 36,0                      | 6,0                      | 4410                            | 29,4                     | 1,90                              | 12,3                                       | 200 000  | 5,2                |
| F 44 – 44 | LL 2844                      |         |        | 4 x 4              |   |                           |                          |                                 | 54,7                     | 3,80                              | 36,8                                       | 400 000  | 10,4               |
| F 44 – 66 | LL 2866                      |         |        | 6 x 6              |   |                           |                          |                                 | 80,2                     | 5,70                              | 61,4                                       | 600 000  | 15,6               |
| F 44 – 88 | LL 2888                      |         |        | 8 x 8              |   |                           |                          |                                 | 105,4                    | 7,60                              | 86,5                                       | 800 000  | 20,8               |
| F 50 – 22 | LL 3222                      | 2,00    | 50,8   | 2 x 2              | 17,81                                       | 41,2                      | 6,3                      | 5048                            | 32,5                     | 2,24                              | 12,9                                       | 250 000  | 6,5                |
| F 50 – 44 | LL 3244                      |         |        | 4 x 4              |   |                           |                          |                                 | 59,1                     | 4,47                              | 39,1                                       | 500 000  | 12,8               |
| F 50 – 66 | LL 3266                      |         |        | 6 x 6              |   |                           |                          |                                 | 85,4                     | 6,71                              | 65,6                                       | 750 000  | 19,1               |
| F 50 – 88 | LL 3288                      |         |        | 8 x 8              |   |                           |                          |                                 | 112,0                    | 8,94                              | 92,0                                       | 1 000 000  | 25,3               |
| F 63 – 22 | LL 4022                      | 2,50    | 63,5   | 2 x 2              | 22,89                                       | 48,0                      | 8,0                      | 6340                            | 39,5                     | 3,65                              | 16,3                                       | 355 000  | 9,2                |
| F 63 – 44 | LL 4044                      |         |        | 4 x 4              |   |                           |                          |                                 | 73,1                     | 7,30                              | 49,4                                       | 710 000  | 17,7               |
| F 63 – 66 | LL 4066                      |         |        | 6 x 6              |   |                           |                          |                                 | 106,5                    | 10,94                             | 82,7                                       | 1 065 000  | 26,9               |
| F 63 – 88 | LL 4088                      |         |        | 8 x 8              |   |                           |                          |                                 | 139,9                    | 14,60                             | 116,0                                      | 1 420 000  | 35,1               |
| F 76 – 22 | LL 4822                      | 3,00    | 76,2   | 2 x 2              | 29,24                                       | 62,0                      | 10,0                     | 7620                            | 49,7                     | 5,83                              | 20,3                                       | 560 000  | 15,4               |
| F 76 – 44 | LL 4844                      |         |        | 4 x 4              |   |                           |                          |                                 | 91,2                     | 11,66                             | 60,6                                       | 1 120 000  | 30,2               |
| F 76 – 66 | LL 4866                      |         |        | 6 x 6              |   |                           |                          |                                 | 131,0                    | 17,50                             | 101,0                                      | 1 680 000  | 45,0               |
| F 76 – 88 | LL 4888                      |         |        | 8 x 8              |   |                           |                          |                                 | 172,8                    | 23,30                             | 144,0                                      | 2 240 000  | 59,8               |

### Leaf chains, American standard, Light series

| Chain No. | Chain description<br>ISO DIN | Pitch p |        | Plate combinations | Pin $\varnothing$<br>d <sub>1</sub> max. mm | Link plate height<br>g mm | Link plate thick<br>s mm | Length over 100 x Pitch<br>■ mm | Total width<br>B max. mm | Bearing area<br>A cm <sup>2</sup> | Link plate width<br>b <sub>3</sub> min. mm | Min. ultimate strength*)<br>F <sub>B</sub> N | Weight<br>≈ q kg/m |
|-----------|------------------------------|---------|--------|--------------------|---|---------------------------|--------------------------|---------------------------------|--------------------------|-----------------------------------|--|--|--------------------|
|           |                              | inch    | mm     |                    |   |                           |                          |                                 |                          |                                   |  |  |                    |
|           |                              |         |        |                    |   |                           |                          |                                 |                          |                                   |  |  |                    |
| AL 422    | –                            | 0,50    | 12,7   | 2 x 2              | 3,96  | 10,2                      | 1,5                      | 1257                            | 8,4                      | 0,12                              | 3,2  | 14 100                                       | 0,35               |
| AL 444    | –                            |         |        | 4 x 4              |   |                           |                          |                                 | 14,8                     | 0,23                              | 9,6  | 28 200                                       | 0,67               |
| AL 466    | –                            |         |        | 6 x 6              |   |                           |                          |                                 | 21,2                     | 0,35                              | 16,0                                       | 42 300                                       | 1,0                |
| AL 522    | –                            | 0,625   | 15,875 | 2 x 2              | 5,08  | 12,8                      | 2,0                      | 1572                            | 10,8                     | 0,2                               | 4,2  | 22 000                                       | 0,6                |
| AL 544    | –                            |         |        | 4 x 4              |   |                           |                          |                                 | 19,2                     | 0,4                               | 12,6                                       | 44 000                                       | 1,2                |
| AL 566    | –                            |         |        | 6 x 6              |   |                           |                          |                                 | 21,7                     | 0,6                               | 21,0                                       | 66 000                                       | 1,8                |
| AL 622    | –                            | 0,75    | 19,05  | 2 x 2              | 5,94  | 14,8                      | 2,4                      | 1909                            | 12,8                     | 0,28                              | 5,0  | 37 000                                       | 0,9                |
| AL 644    | –                            |         |        | 4 x 4              |   |                           |                          |                                 | 23,0                     | 0,57                              | 15,0                                       | 63 600                                       | 1,7                |
| AL 666    | –                            |         |        | 6 x 6              |   |                           |                          |                                 | 33,1                     | 0,85                              | 25,0                                       | 95 400                                       | 2,5                |
| AL 688    | –                            |         |        | 8 x 8              |   |                           |                          |                                 | 43,2                     | 1,14                              | 35,0                                       | 127 200                                      | 3,3                |
| AL 822    | –                            | 1,00    | 25,4   | 2 x 2              | 7,92  | 20,5                      | 3,1                      | 2540                            | 16,6                     | 0,51                              | 6,3  | 56 700                                       | 1,5                |
| AL 844    | –                            |         |        | 4 x 4              |   |                           |                          |                                 | 29,7                     | 1,01                              | 19,0                                       | 113 400                                      | 3,0                |
| AL 866    | –                            |         |        | 6 x 6              |   |                           |                          |                                 | 42,7                     | 1,52                              | 31,8                                       | 170 100                                      | 4,5                |
| AL 1044   | –                            | 1,25    | 31,75  | 4 x 4              | 9,53  | 25,7                      | 4,0                      | 3175                            | 37,3                     | 1,52                              | 24,6                                       | 177 000                                      | 4,9                |
| AL 1066   | –                            |         |        | 6 x 6              |   |                           |                          |                                 | 54,0                     | 2,29                              | 41,0                                       | 265 500                                      | 7,3                |
| AL 1244   | –                            | 1,50    | 38,1   | 4 x 4              | 11,1  | 29,4                      | 4,7                      | 3810                            | 43,7                     | 2,08                              | 28,8                                       | 254 000                                      | 6,4                |
| AL 1266   | –                            |         |        | 6 x 6              |   |                           |                          |                                 | 63,4                     | 3,12                              | 48,0                                       | 381 000                                      | 9,5                |
| AL 1288   | –                            |         |        | 8 x 8              |   |                           |                          |                                 | 83,0                     | 4,17                              | 67,2                                       | 508 000                                      | 12,7               |
| AL 1444   | –                            | 1,75    | 44,45  | 4 x 4              | 12,7  | 36,0                      | 5,5                      | 4445                            | 51,2                     | 2,8                               | 33,6                                       | 372 000                                      | 9,6                |
| AL 1466   | –                            |         |        | 6 x 6              |   |                           |                          |                                 | 74,5                     | 4,2                               | 56,0                                       | 558 000                                      | 14,4               |
| AL 1666   | –                            | 2,00    | 50,8   | 6 x 6              | 14,27                                       | 41,2                      | 6,3                      | 5080                            | 85,0                     | 5,39                              | 64,0                                       | 642 000                                      | 18,9               |

\*) Details about the effective higher Rexnord ultimate strengths and fatigue strength values are available upon request.

# Fastening of leaf chains

## Connecting pins for leaf chain fastening to fastening blocks

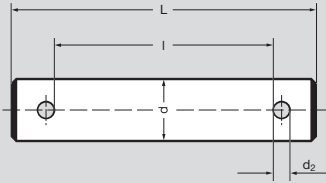

Each pin is fitted with 2 cotters and as from BL 1234 i.e. F 38 additionally with 2 washers.

| Chain No.   | Connecting pin Order No. | Connecting pin dimensions (in mm) |        |        |                |
|-------------|--------------------------|-----------------------------------|--------|--------|----------------|
|             |                          | l min.                            | L max. | d max. | d <sub>2</sub> |
| F 12 - 44   | 709 - 204 - 44           | 16.0                              | 22.2   | 4.45   | 1.6            |
| F 12 - 66   | 709 - 204 - 66           | 23.0                              | 29.2   |        |                |
| F 15 - 44   | 709 - 205 - 44           | 15.0                              | 21.1   | 5.08   | 1.6            |
| F 15 - 66   | 709 - 205 - 66           | 22.0                              | 28.2   |        |                |
| F 19 - 44   | 709 - 405 - 44           | 17.6                              | 25.5   | 5.72   | 2.0            |
| F 19 - 66   | 709 - 405 - 66           | 24.7                              | 32.7   |        |                |
| F 25 - 44   | 709 - 208 - 44           | 28.0                              | 38.7   | 8.28   | 3.2            |
| F 25 - 66   | 709 - 208 - 66           | 41.0                              | 51.7   |        |                |
| F 25 - 88   | 709 - 208 - 88           | 54.0                              | 64.7   |        |                |
| F 31 - 44   | 709 - 210 - 44           | 33.0                              | 43.7   | 10.19  | 3.2            |
| F 31 - 66   | 709 - 210 - 66           | 47.0                              | 57.7   |        |                |
| F 31 - 88   | 709 - 210 - 88           | 62.0                              | 72.7   |        |                |
| F 38 - 44   | 709 - 214 - 44           | 48.2                              | 60.6   | 14.63  | 4.0            |
| F 38 - 66   | 709 - 214 - 66           | 69.2                              | 81.6   |        |                |
| F 38 - 88   | 709 - 214 - 88           | 90.2                              | 102.6  |        |                |
| F 44 - 22   | 709 - 215 - 22           | 29.7                              | 42.1   | 15.9   | 4.0            |
| F 44 - 44   | 709 - 215 - 44           | 55.0                              | 67.5   |        |                |
| F 44 - 66   | 709 - 215 - 66           | 80.2                              | 92.7   |        |                |
| F 44 - 88   | 709 - 215 - 88           | 106.0                             | 118.5  |        |                |
| F 50 - 22   | 709 - 217 - 22           | 34.4                              | 51.9   |        |                |
| F 50 - 44   | 709 - 217 - 44           | 59.9                              | 77.5   |        |                |
| F 50 - 66   | 709 - 217 - 66           | 86.4                              | 104.0  |        |                |
| F 50 - 88   | 709 - 217 - 88           | 113.9                             | 131.5  |        |                |
| F 63 - 22   | 709 - 222 - 22           | 39.9                              | 60.8   | 22.89  | 6.3            |
| F 63 - 44   | 709 - 222 - 44           | 73.3                              | 94.3   |        |                |
| F 63 - 66   | 709 - 222 - 66           | 106.6                             | 127.6  |        |                |
| F 63 - 88   | 709 - 222 - 88           | 140.1                             | 161.1  |        |                |
| F 76 - 44   | 709 - 229 - 44           | 91.5                              | 112.5  | 29.23  | 6.3            |
| F 76 - 66   | 709 - 229 - 66           | 133.5                             | 154.5  |        |                |
| F 76 - 88   | 709 - 229 - 88           | 174.2                             | 195.2  |        |                |
| F 19 V - 44 | 709 - 206 - 44           | 23.0                              | 30.2   | 6.5    | 2.0            |
| F 19 V - 66 | 709 - 206 - 66           | 33.0                              | 40.3   |        |                |

| Chain No.       | Connecting pin Order No. | Connecting pin dimensions (in mm) |        |        |                |
|-----------------|--------------------------|-----------------------------------|--------|--------|----------------|
|                 |                          | l min.                            | L max. | d max. | d <sub>2</sub> |
| BL 422/AL 522   | 709 - 305 - 22           | 10.8                              | 17.0   | 5.08   | 1.6            |
| BL 423          | 709 - 305 - 23           | 12.7                              | 18.9   |        |                |
| BL 434          | 709 - 305 - 34           | 17.0                              | 23.2   |        |                |
| BL 444/AL 544   | 709 - 305 - 44           | 19.0                              | 25.2   |        |                |
| BL 446          | 709 - 305 - 46           | 23.0                              | 29.2   |        |                |
| BL 466/AL 566   | 709 - 305 - 66           | 27.0                              | 33.3   |        |                |
| BL 488/AL 588   | 709 - 305 - 88           | 35.5                              | 41.8   | 5.94   | 2.0            |
| BL 522/AL 622   | 709 - 355 - 22           | 12.8                              | 19.4   |        |                |
| BL 523          | 709 - 355 - 23           | 15.0                              | 21.6   |        |                |
| BL 534          | 709 - 355 - 34           | 20.0                              | 26.6   |        |                |
| BL 544/AL 644   | 709 - 355 - 44           | 22.5                              | 29.1   |        |                |
| BL 546          | 709 - 355 - 46           | 27.0                              | 33.7   |        |                |
| BL 566/AL 666   | 709 - 355 - 66           | 32.0                              | 38.7   |        |                |
| BL 588/AL 688   | 709 - 355 - 88           | 42.5                              | 49.3   | 7.92   | 3.2            |
| BL 623          | 709 - 307 - 23           | 20.0                              | 30.7   |        |                |
| BL 634          | 709 - 307 - 34           | 27.0                              | 37.7   |        |                |
| BL 644/AL 844   | 709 - 307 - 44           | 30.0                              | 40.7   |        |                |
| BL 646          | 709 - 307 - 46           | 37.0                              | 47.7   |        |                |
| BL 666/AL 866   | 709 - 307 - 66           | 43.0                              | 53.7   |        |                |
| BL 688/AL 888   | 709 - 307 - 88           | 56.5                              | 67.2   | 9.53   | 3.2            |
| BL 823          | 709 - 309 - 23           | 25.0                              | 35.7   |        |                |
| BL 834          | 709 - 309 - 34           | 33.0                              | 43.7   |        |                |
| BL 844/AL 1044  | 709 - 309 - 44           | 37.0                              | 47.7   |        |                |
| BL 846          | 709 - 309 - 46           | 46.0                              | 56.7   |        |                |
| BL 866/AL 1066  | 709 - 309 - 66           | 53.0                              | 63.7   |        |                |
| BL 888/AL 1088  | 709 - 309 - 88           | 69.5                              | 80.3   | 11.1   | 4.0            |
| BL 1023         | 709 - 311 - 23           | 30.0                              | 42.4   |        |                |
| BL 1034         | 709 - 311 - 34           | 39.2                              | 51.6   |        |                |
| BL 1044/AL 1244 | 709 - 311 - 44           | 44.2                              | 56.6   |        |                |
| BL 1046         | 709 - 311 - 46           | 54.2                              | 66.6   |        |                |
| BL 1066/AL 1266 | 709 - 311 - 66           | 63.2                              | 75.6   |        |                |
| BL 1088/AL 1288 | 709 - 311 - 88           | 79.9                              | 92.4   | 12.7   | 4.0            |
| BL 1223         | 709 - 312 - 23           | 34.5                              | 46.9   |        |                |
| BL 1234         | 709 - 312 - 34           | 46.2                              | 58.6   |        |                |
| BL 1244/AL 1444 | 709 - 312 - 44           | 50.0                              | 64.4   |        |                |
| BL 1246         | 709 - 312 - 46           | 63.5                              | 76.0   |        |                |
| BL 1266/AL 1466 | 709 - 312 - 66           | 75.3                              | 87.8   |        |                |
| BL 1288/AL 1488 | 709 - 312 - 88           | 98.6                              | 111.1  | 14.27  | 4.0            |
| BL 1423         | 709 - 314 - 23           | 38.7                              | 51.1   |        |                |
| BL 1434         | 709 - 314 - 34           | 52.2                              | 64.6   |        |                |
| BL 1444/AL 1644 | 709 - 314 - 44           | 58.6                              | 71.1   |        |                |
| BL 1446         | 709 - 314 - 46           | 71.7                              | 84.2   |        |                |
| BL 1466/AL 1666 | 709 - 314 - 66           | 85.1                              | 97.7   | 17.46  | 5.0            |
| BL 1623         | 709 - 317 - 23           | 43.1                              | 60.6   |        |                |
| BL 1634         | 709 - 317 - 34           | 58.0                              | 75.5   |        |                |
| BL 1644         | 709 - 317 - 44           | 65.7                              | 82.9   |        |                |
| BL 1646         | 709 - 317 - 46           | 79.9                              | 97.4   |        |                |
| BL 1666         | 709 - 317 - 66           | 94.6                              | 112.2  |        |                |
| BL 1688         | 709 - 317 - 88           | 124.0                             | 141.6  |        |                |

## Lacings

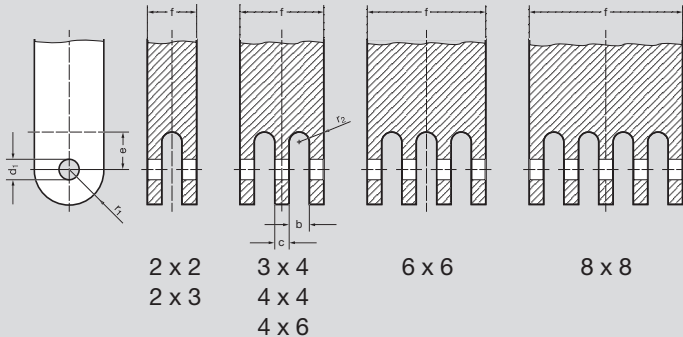

## Recommendations for fastening block dimensions onto leaf chains (inner links)

| Chain No.       | Inner link connector dimensions (in mm) |        |        |                     |        |                     |                     |
|-----------------|---|--------|--------|---------------------|--------|---------------------|---------------------|
|                 | f max.                                  | b min. | c max. | d <sub>1</sub> D 10 | e min. | r <sub>1</sub> max. | r <sub>2</sub> max. |
| BL 422/AL 522   | 10.7                                    | 4.2    | –      |                     |        |                     | 2.0                 |
| BL 423          | 12.6                                    | 6.4    | –      |                     |        |                     | 3.0                 |
| BL 434          | 16.9                                    | 4.2    | 2.0    |                     |        |                     | 2.0                 |
| BL 444/AL 544   | 18.9                                    | 4.2    | 4.0    | 5.1                 | 9.0    | 6.5                 | 2.0                 |
| BL 446          | 22.9                                    | 6.4    | 4.0    |                     |        |                     | 3.0                 |
| BL 466/AL 566   | 26.9                                    | 4.2    | 4.0    |                     |        |                     | 2.0                 |
| BL 488/AL 588   | 35.4                                    | 4.2    | 4.0    |                     |        |                     | 2.0                 |
| BL 522/AL 622   | 12.7                                    | 5.0    | –      |                     |        |                     | 2.0                 |
| BL 523          | 14.9                                    | 7.5    | –      |                     |        |                     | 2.0                 |
| BL 534          | 19.9                                    | 5.0    | 2.4    |                     |        |                     | 2.0                 |
| BL 544/AL 644   | 22.4                                    | 5.0    | 4.8    | 6.0                 | 11.0   | 8.0                 | 2.0                 |
| BL 546          | 26.9                                    | 7.5    | 4.8    |                     |        |                     | 2.0                 |
| BL 566/AL 666   | 31.9                                    | 5.0    | 4.8    |                     |        |                     | 2.0                 |
| BL 588/AL 688   | 42.4                                    | 5.0    | 4.8    |                     |        |                     | 2.0                 |
| BL 623          | 19.9                                    | 10.3   | –      |                     |        |                     | 5.0                 |
| BL 634          | 26.9                                    | 6.8    | 3.2    |                     |        |                     | 3.0                 |
| BL 644/AL 844   | 29.9                                    | 6.8    | 6.4    |                     |        |                     | 3.0                 |
| BL 646          | 36.9                                    | 10.3   | 6.4    | 8.0                 | 14.0   | 9.5                 | 5.0                 |
| BL 666/AL 866   | 42.9                                    | 6.8    | 6.4    |                     |        |                     | 3.0                 |
| BL 688/AL 888   | 56.4                                    | 6.8    | 6.4    |                     |        |                     | 3.0                 |
| BL 823          | 24.9                                    | 12.8   | –      |                     |        |                     | 6.0                 |
| BL 834          | 32.9                                    | 8.5    | 4.0    |                     |        |                     | 4.0                 |
| BL 844/AL 1044  | 36.9                                    | 8.5    | 8.0    |                     |        |                     | 4.0                 |
| BL 846          | 45.9                                    | 12.8   | 8.0    | 9.6                 | 18.0   | 12.5                | 6.0                 |
| BL 866/AL 1066  | 52.9                                    | 8.5    | 8.0    |                     |        |                     | 4.0                 |
| BL 888/AL 1088  | 69.4                                    | 8.5    | 8.0    |                     |        |                     | 4.0                 |
| BL 1023         | 29.8                                    | 15.1   | –      |                     |        |                     | 7.0                 |
| BL 1034         | 39.0                                    | 10.0   | 4.7    |                     |        |                     | 5.0                 |
| BL 1044/AL 1244 | 44.0                                    | 10.0   | 9.4    |                     |        |                     | 5.0                 |
| BL 1046         | 54.0                                    | 15.1   | 9.4    | 11.2                | 22.0   | 15.0                | 7.0                 |
| BL 1066/AL 1266 | 63.0                                    | 10.0   | 9.4    |                     |        |                     | 5.0                 |
| BL 1088/AL 1288 | 79.7                                    | 10.0   | 9.4    |                     |        |                     | 5.0                 |
| BL 1223         | 34.3                                    | 17.7   | –      |                     |        |                     | 8.0                 |
| BL 1234         | 46.0                                    | 11.8   | 5.5    |                     |        |                     | 5.0                 |
| BL 1244/AL 1444 | 49.0                                    | 11.8   | 11.0   |                     |        |                     | 5.0                 |
| BL 1246         | 63.3                                    | 17.7   | 11.0   | 12.8                | 26.0   | 19.0                | 8.0                 |
| BL 1266/AL 1466 | 75.1                                    | 11.8   | 11.0   |                     |        |                     | 5.0                 |
| BL 1288/AL 1488 | 98.4                                    | 11.8   | 11.0   |                     |        |                     | 5.0                 |
| BL 1423         | 38.5                                    | 20.1   | –      |                     |        |                     | 10.0                |
| BL 1434         | 52.0                                    | 13.4   | 6.3    |                     |        |                     | 6.0                 |
| BL 1444/AL 1644 | 58.4                                    | 13.4   | 12.6   | 14.3                | 31.0   | 22.0                | 6.0                 |
| BL 1446         | 71.5                                    | 20.1   | 12.6   |                     |        |                     | 10.0                |
| BL 1466/AL 1666 | 84.9                                    | 13.4   | 12.6   |                     |        |                     | 6.0                 |
| BL 1623         | 42.8                                    | 22.5   | –      |                     |        |                     | 10.0                |
| BL 1634         | 57.7                                    | 15.0   | 7.1    |                     |        |                     | 7.0                 |
| BL 1644         | 65.4                                    | 15.0   | 14.2   |                     |        |                     | 7.0                 |
| BL 1646         | 79.6                                    | 22.5   | 14.2   | 17.5                | 34.0   | 25.0                | 10.0                |
| BL 1666         | 94.3                                    | 15.0   | 14.2   |                     |        |                     | 7.0                 |
| BL 1688         | 123.7                                   | 15.0   | 14.2   |                     |        |                     | 7.0                 |

| Chain No.   | Inner link connector dimensions (in mm) |        |        |                     |        |                     |                     |
|-------------|---|--------|--------|---------------------|--------|---------------------|---------------------|
|             | f max.                                  | b min. | c max. | d <sub>1</sub> D 10 | e min. | r <sub>1</sub> max. | r <sub>2</sub> max. |
| F 12 – 44   | 15.9                                    | 3.5    | 3.0    | 4.5                 | 7.3    | 6.5                 | 1.7                 |
| F 12 – 66   | 22.9                                    | 3.5    | 3.0    | 4.5                 | 7.3    | 6.5                 | 1.7                 |
| F 15 – 44   | 14.9                                    | 3.5    | 3.0    | 5.1                 | 8.5    | 8.0                 | 1.7                 |
| F 15 – 66   | 21.9                                    | 3.5    | 3.0    | 5.1                 | 8.5    | 8.0                 | 1.7                 |
| F 19 – 44   | 17.5                                    | 4.1    | 3.6    | 5.75                | 10.0   | 9.5                 | 1.7                 |
| F 19 – 66   | 24.6                                    | 4.1    | 3.6    | 5.75                | 10.0   | 9.5                 | 1.7                 |
| F 25 – 44   | 27.9                                    | 6.7    | 6.2    | 8.3                 | 13.5   | 13.0                | 3.0                 |
| F 25 – 66   | 40.9                                    | 6.7    | 6.2    | 8.3                 | 13.5   | 13.0                | 3.0                 |
| F 25 – 88   | 53.9                                    | 6.7    | 6.2    | 8.3                 | 13.5   | 13.0                | 3.0                 |
| F 31 – 44   | 32.9                                    | 7.5    | 7.0    | 10.2                | 17.0   | 16.5                | 3.5                 |
| F 31 – 66   | 46.9                                    | 7.5    | 7.0    | 10.2                | 17.0   | 16.5                | 3.5                 |
| F 31 – 88   | 61.9                                    | 7.5    | 7.0    | 10.2                | 17.0   | 16.5                | 3.5                 |
| F 38 – 44   | 48.0                                    | 11.0   | 10.0   | 14.7                | 22.0   | 20.0                | 5.0                 |
| F 38 – 66   | 69.0                                    | 11.0   | 10.0   | 14.7                | 22.0   | 20.0                | 5.0                 |
| F 38 – 88   | 90.9                                    | 11.0   | 10.0   | 14.7                | 22.0   | 20.0                | 5.0                 |
| F 44 – 22   | 29.5                                    | 13.0   | 12.0   | 16.0                | 25.0   | 24.0                | 6.0                 |
| F 44 – 44   | 54.8                                    | 13.0   | 12.0   | 16.0                | 25.0   | 24.0                | 6.0                 |
| F 44 – 66   | 80.0                                    | 13.0   | 12.0   | 16.0                | 25.0   | 24.0                | 6.0                 |
| F 44 – 88   | 105.8                                   | 13.0   | 12.0   | 16.0                | 25.0   | 24.0                | 6.0                 |
| F 50 – 22   | 34.2                                    | 13.6   | 12.6   | 17.9                | 28.0   | 27.0                | 6.0                 |
| F 50 – 44   | 59.7                                    | 13.6   | 12.6   | 17.9                | 28.0   | 27.0                | 6.0                 |
| F 50 – 66   | 86.2                                    | 13.6   | 12.6   | 17.9                | 28.0   | 27.0                | 6.0                 |
| F 50 – 88   | 113.7                                   | 13.6   | 12.6   | 17.9                | 28.0   | 27.0                | 6.0                 |
| F 63 – 22   | 39.6                                    | 17.0   | 16.0   | 23.0                | 35.0   | 35.0                | 8.0                 |
| F 63 – 44   | 73.0                                    | 17.0   | 16.0   | 23.0                | 35.0   | 35.0                | 8.0                 |
| F 63 – 66   | 106.3                                   | 17.0   | 16.0   | 23.0                | 35.0   | 35.0                | 8.0                 |
| F 63 – 88   | 139.8                                   | 17.0   | 16.0   | 23.0                | 35.0   | 35.0                | 8.0                 |
| F 76 – 44   | 91.2                                    | 21.0   | 20.0   | 29.3                | 45.0   | 40.0                | 10.0                |
| F 76 – 66   | 133.2                                   | 21.0   | 20.0   | 29.3                | 45.0   | 40.0                | 10.0                |
| F 76 – 88   | 173.9                                   | 21.0   | 20.0   | 29.3                | 45.0   | 40.0                | 10.0                |
| F 19 V – 44 | 22.9                                    | 5.2    | 4.7    | 6.6                 | 10.0   | 10.5                | 2.0                 |
| F 19 V – 66 | 32.9                                    | 5.2    | 4.7    | 6.6                 | 10.0   | 10.5                | 2.0                 |

For more information visit our website [www.rexnord.eu](http://www.rexnord.eu)

## Fastening of leaf chains

### End plates as inner links

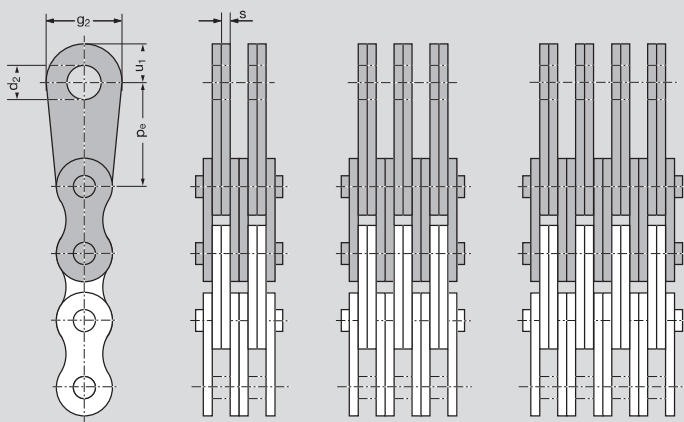

Scope of delivery:  
End plate (pear-shaped) as well as leaf chain outer link supplied as complete sub-assembly for riveting.

### End plates as outer links

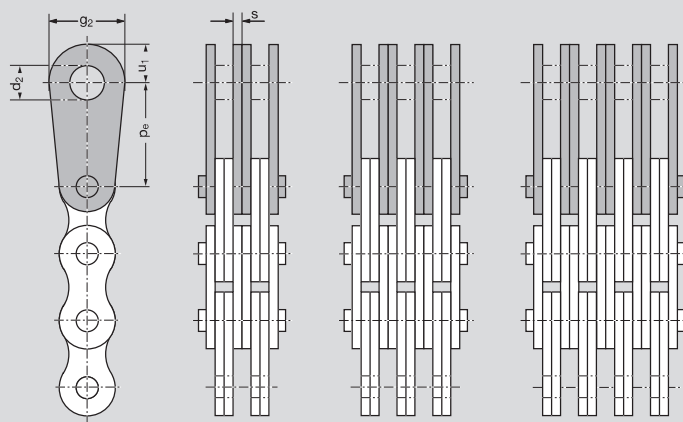

Scope of delivery:  
End plate (pear-shaped) as well as corresponding rivet pin for riveting.

| Chain Order No. | End plates     |     | Dimensions (in mm) |                    |                |      |                |
|-----------------|----------------|-----|--------------------|--------------------|----------------|------|----------------|
|                 | IEG            | AEG | Pe                 | d <sub>2</sub> A11 | g <sub>2</sub> | s    | u <sub>1</sub> |
| F 12 - 44       | 170 - 112 - 44 | 45  | 15                 | 6                  | 16.0           | 1.7  | 10.0           |
| F 12 - 66       | 170 - 112 - 66 | 65  |                    |                    |                |      |                |
| F 15 - 44       | 170 - 115 - 44 | 45  | 20                 | 8                  | 18.0           | 1.5  | 11.0           |
| F 15 - 66       | 170 - 115 - 66 | 65  |                    |                    |                |      |                |
| F 25 - 44       | 170 - 124 - 44 | 45  | 30                 | 12                 | 25.0           | 3.0  | 15.0           |
| F 25 - 66       | 170 - 124 - 66 | 65  |                    |                    |                |      |                |
| F 25 - 88       | 170 - 124 - 88 | 85  |                    |                    |                |      |                |
| F 31 - 44       | 170 - 131 - 44 | 45  | 50                 | 18                 | 40.0           | 3.5  | 25.0           |
| F 31 - 66       | 170 - 131 - 66 | 65  |                    |                    |                |      |                |
| F 31 - 88       | 170 - 131 - 88 | 85  |                    |                    |                |      |                |
| F 38 - 44       | 170 - 138 - 44 | 45  | 65                 | 24                 | 50.0           | 5.0  | 29.0           |
| F 38 - 66       | 170 - 138 - 66 | 65  |                    |                    |                |      |                |
| F 38 - 88       | 170 - 138 - 88 | 85  |                    |                    |                |      |                |
| F 44 - 22       | 170 - 144 - 22 | 25  | 80                 | 28                 | 60.0           | 6.0  | 32.0           |
| F 44 - 44       | 170 - 144 - 44 | 45  |                    |                    |                |      |                |
| F 44 - 66       | 170 - 144 - 66 | 65  |                    |                    |                |      |                |
| F 50 - 22       | 170 - 150 - 22 | 25  | 90                 | 32                 | 70.0           | 6.3  | 43.0           |
| F 50 - 88       | 170 - 150 - 88 | 85  |                    |                    |                |      |                |
| F 63 - 44       | 170 - 163 - 44 | 45  | 100                | 38                 | 80.0           | 8.0  | 46.5           |
| F 63 - 66       | 170 - 163 - 66 | 65  |                    |                    |                |      |                |
| AL 644          | 170 - 118 - 44 | 45  | 25                 | 10                 | 19.8           | 2.4  | 11.2           |
| AL 666          | 170 - 118 - 66 | 65  |                    |                    |                |      |                |
| AL 688          | 170 - 118 - 88 | 85  |                    |                    |                |      |                |
| AL 1044         | 170 - 130 - 44 | 45  | 40                 | 14                 | 30.0           | 4.0  | 18.0           |
| AL 1066         | 170 - 130 - 66 | 65  |                    |                    |                |      |                |
| F 19 V 44       | 170 - 120 - 44 | 45  | 25                 | 10                 | 19.8           | 2.35 | 11.2           |
| F 19 V 66       | 170 - 120 - 66 | 65  |                    |                    |                |      |                |

End plates are available as inner and outer links.

**Example for ordering** end plates for leaf chain F 38-44:

**a) as IEG (inner Link): 170-138-44**

**b) as AEG (outer link): 170-138-45**